

# PORTA Va e Vieni - mod. VV

- ① LAMINATO IN VETRORESINA / LAMIERA / INOX
- ② CERNIERA SPECIALE CON FERMO A 90°
- ③ BORDO ANTA IN ALLUMINIO/ INOX
- ④ GUARNIZIONE IN GOMMA
- ⑤ OBLO'
- ⑥ PROTEZIONE INOX
- ⑦ PROTEZIONE ALI D'AEREO (optional)
- ⑧ SUPERFICIE INOX (optional)
- ⑨ TELAIO INOX

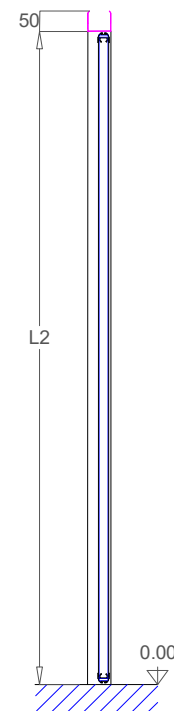

## DIMENSIONAMENTO DEL FORO MURO

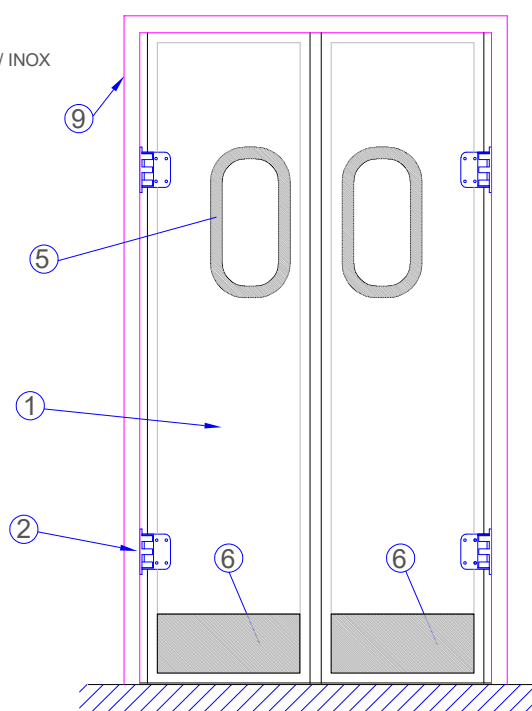
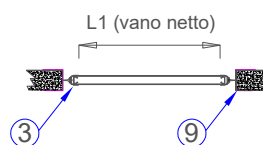
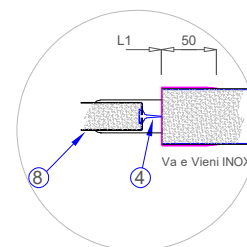
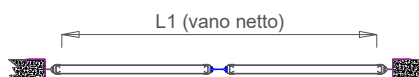
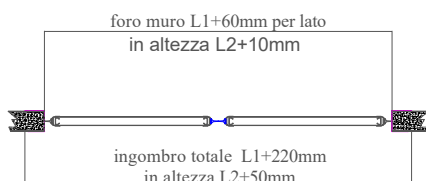

**IMPORTANTE:** se ordinata la porta in base al foro muro, il passaggio netto sarà  $L1-60\text{mm}$  per lato, mentre in altezza  $L2-10\text{mm}$

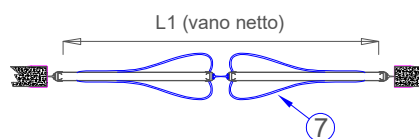

## CARATTERISTICHE TECNICHE

- paramenti esterni in profilati di lamiera preverniciata / VTR per uso alimentare / acciaio inox
- anima in poliuretano rigido espanso, conforme alla legge vigente
- densità media 40 : 42 kg/mc
- borda anta in alluminio anodizzato / acciaio inox
- campo di applicazione  $-60^{\circ}\text{C}$  :  $+100^{\circ}\text{C}$
- percentuale cellule chiuse 95%
- resistenza a compressione 1,5 : 1,8 kc/cm<sup>2</sup>
- autoestingente secondo norme ISO 3582
- conduzione termica per mm :  
sp.40mm  $k = 0,31 \text{ kcal/h mq } ^{\circ}\text{C}$
- guarnizioni in gomma elastica

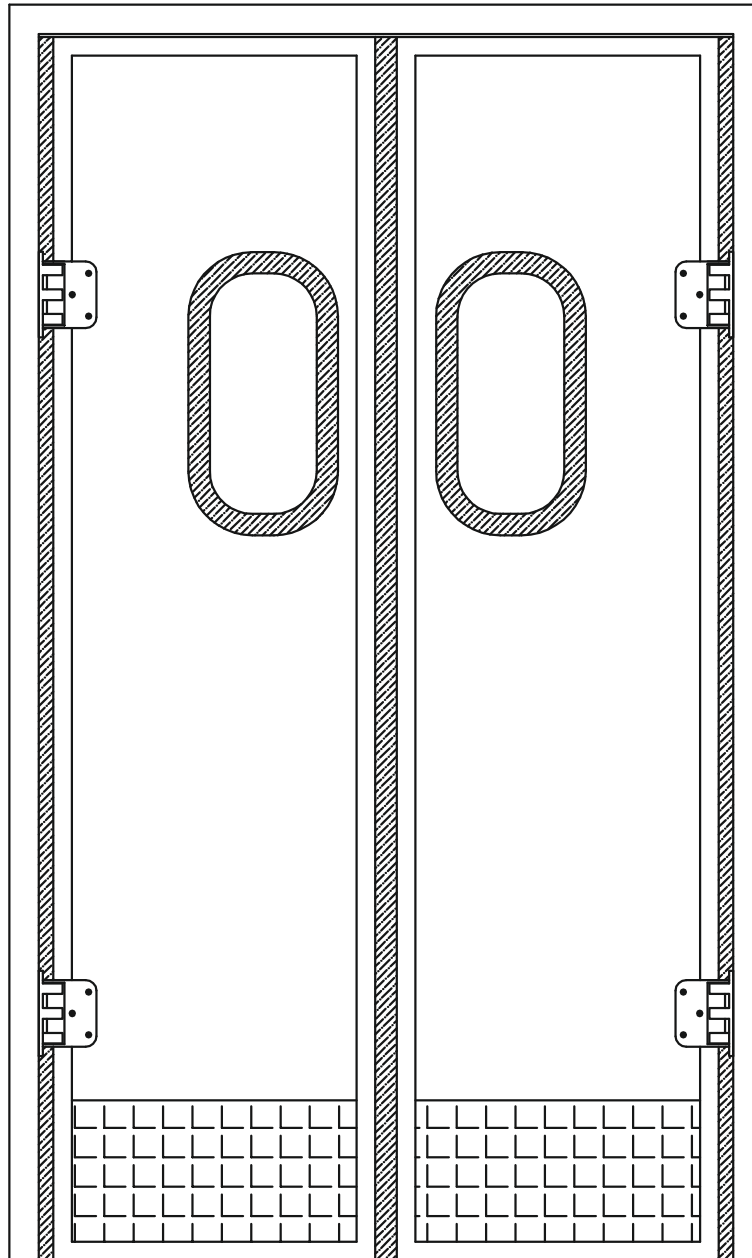

**ISTRUZIONI DI MONTAGGIO**

TRAVERSA SUPERIORE

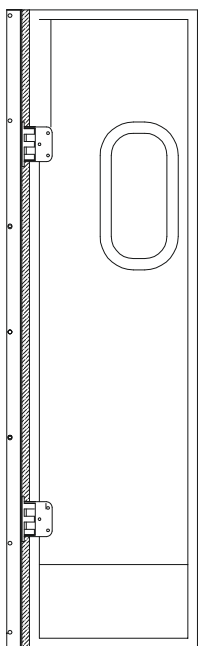
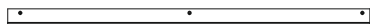

ANTA SX CON PROFILO A U IN INOX MONTATO

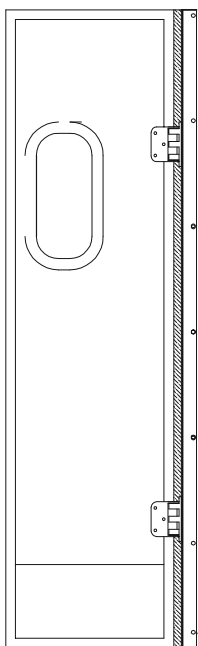

ANTA DX CON PROFILO A U IN INOX MONTATO

**FASE 1**

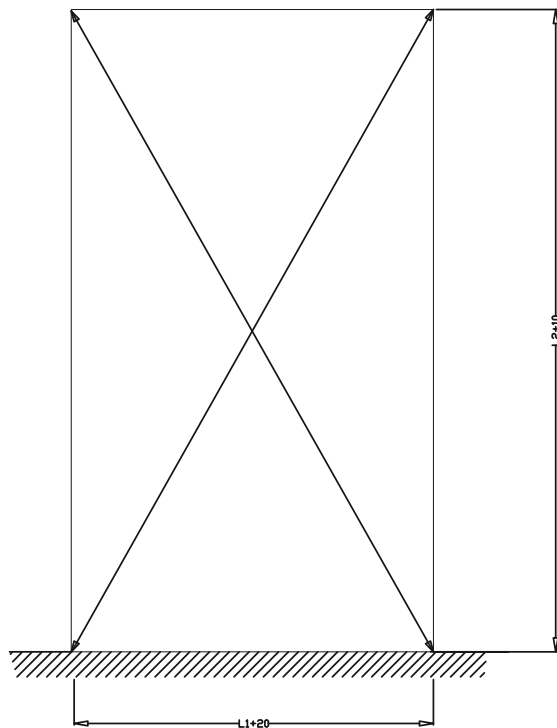

- 1) TAGLIO VANO ( L1+20 / L2+10)
- 2) VERIFICARE LE DIAGONALI

**FASE 2**

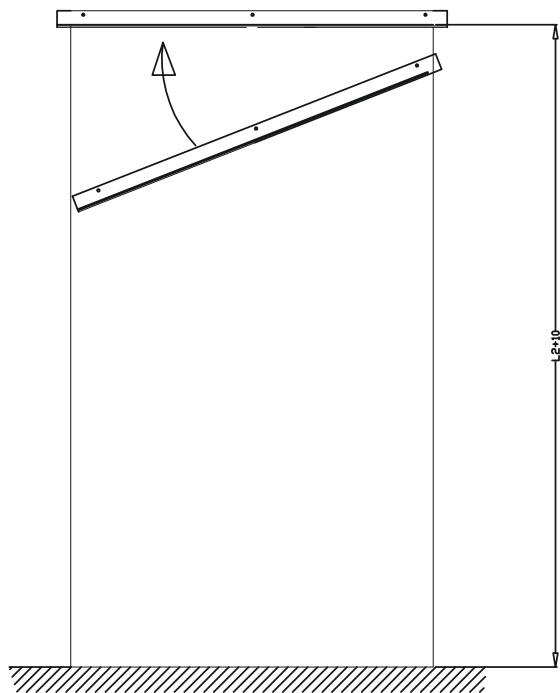

MONTAGGIO TRAVERSA SUPERIORE  
INFILARE IL PROFILO A U INOX AL PANNELLO

**FASE 3**

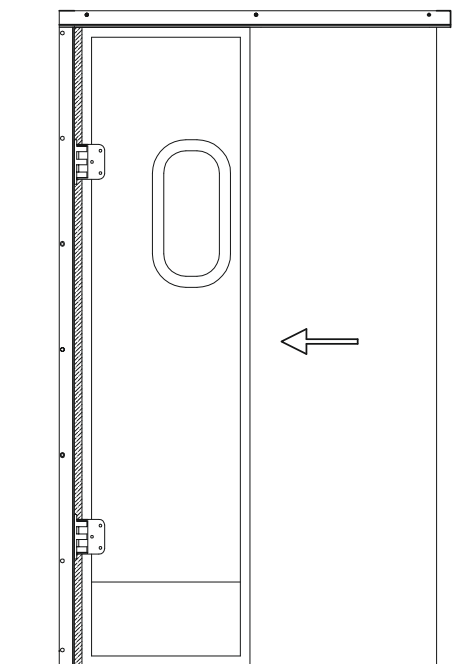

MONTAGGIO PRIMA ANTA  
INFILARE IL PROFILO A U INOX AL PANNELLO

**FASE 4**

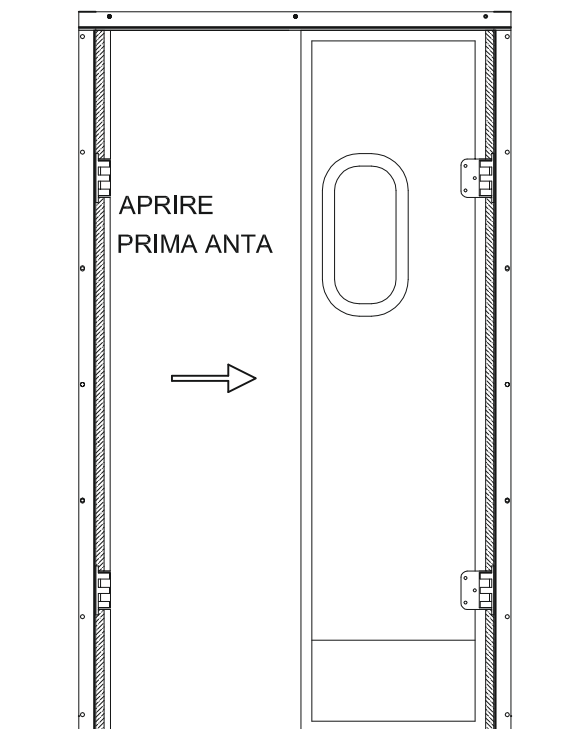

MONTAGGIO SECONDA ANTA  
- INFILARE IL PROFILO U INOX AL PANNELLO

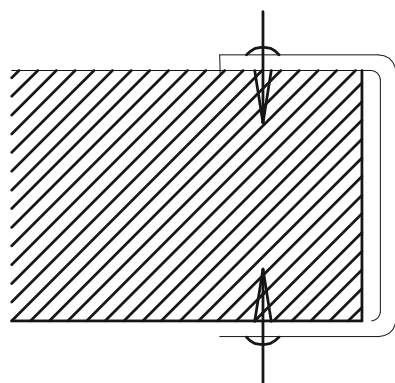
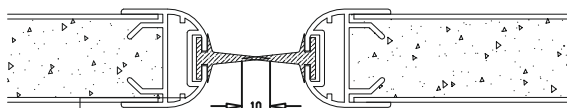

FISSARE CON RIVETTI O VITI

**FASE 5**

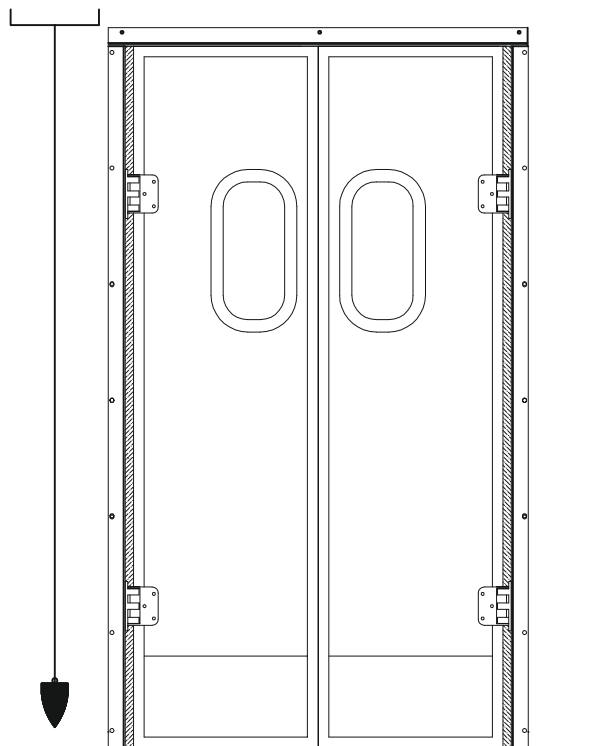

- METTERE IN BOLLA VERTICALMENTE I MONTANTI DELLE DUE ANTE
- LA SOVRAPPOSIZIONE DELLE GUARNIZIONI CENTRALI DOVRA ESSERE DI 10 mm.
- METTERE IN BOLLA ORIZZONTALE LA TRAVERSA SUPERIORE
- FISSARE CON VITI O RIVETTI IL PROFILO U INOX

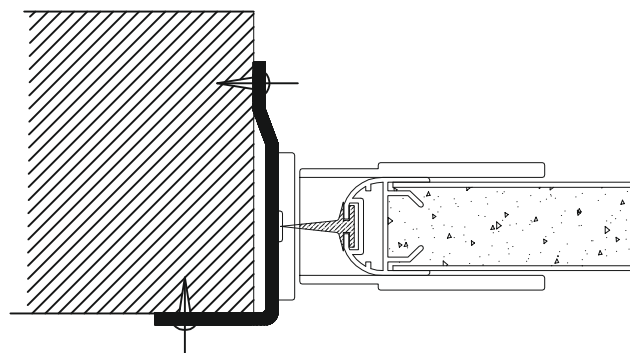

FISSAGGIO SU MURO CON TASSELLI

FASE 1

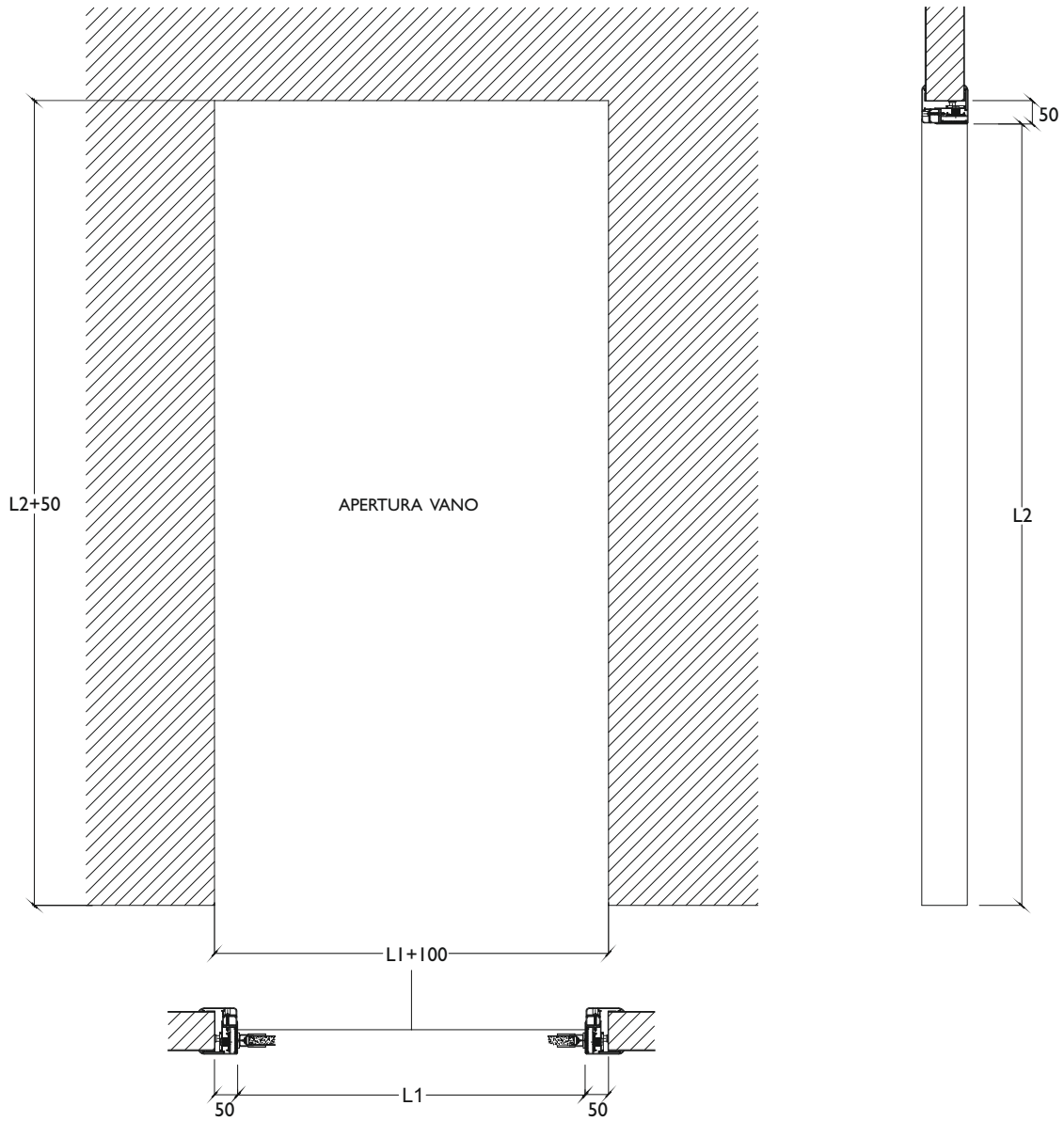

FISSARE IL PROFILO IN LAMIERA ZINCATA CON RIVETTI AL PANNELLO IN CORRISPONDENZA DEI PRESSORI

