

- 1) Fiberglass Facing
- 2) Stay open 90° hinge
- 3) Aluminium edge
- 4) Rubber gasket
- 5) Porthole
- 6) S/S Kickplate
- 7) Trolley bumper(optional)
- 8) S/S facing
- 9) Stainless steel frame

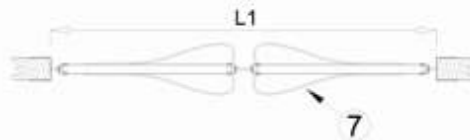

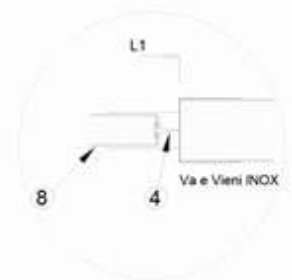
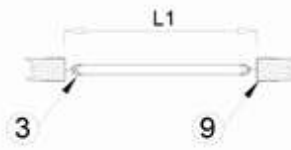
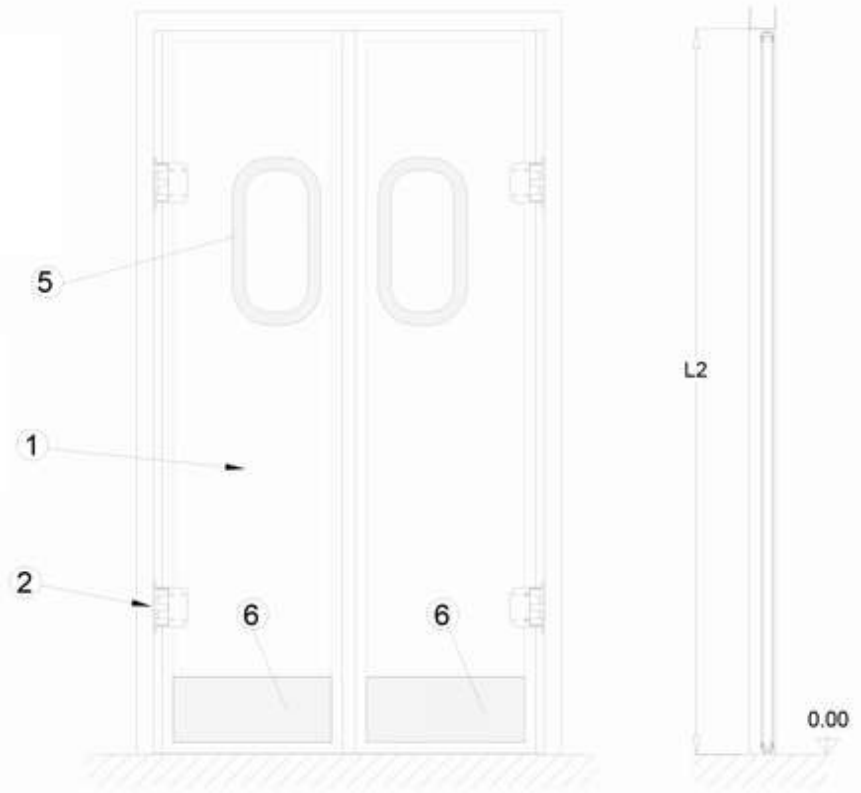
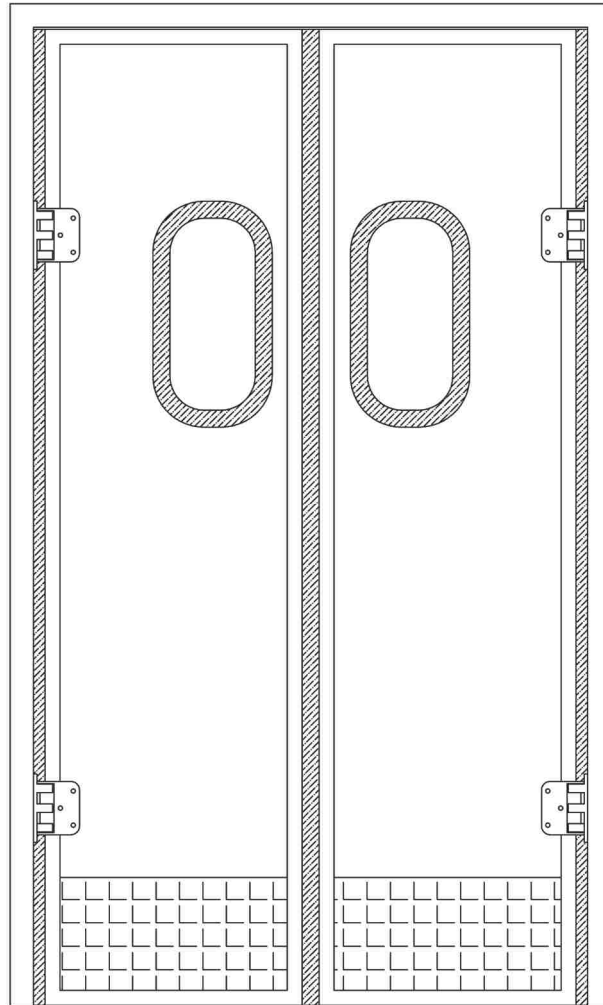

ASSEMBLY INSTRUCTIONS

UPPER CROSS MEMBER



STEP 1

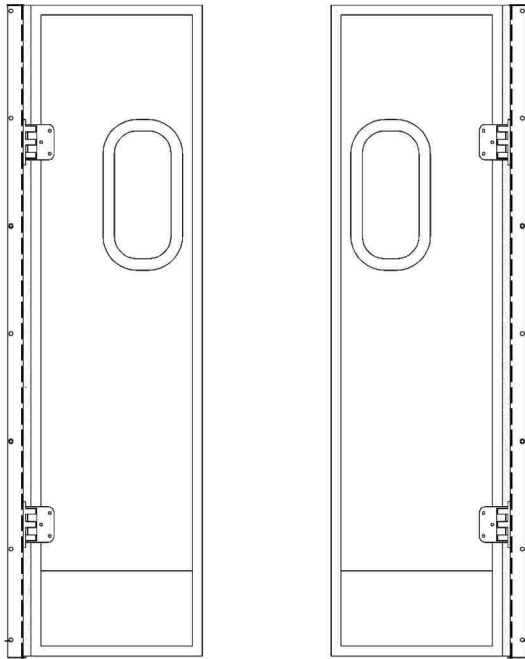

Left wing with stainless steel U section

Right wing with stainless steel U section

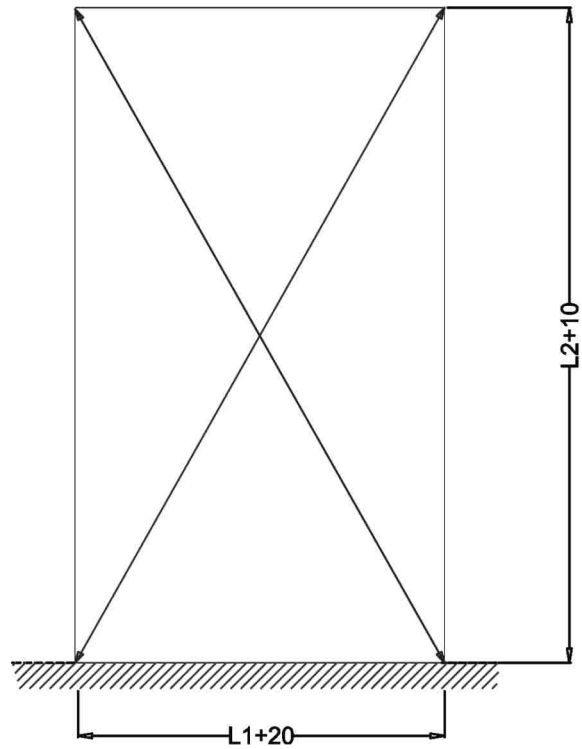

1. Cut door case ($L1+20/L2+10$)
2. Check diagonals

STEP 2

STEP 3

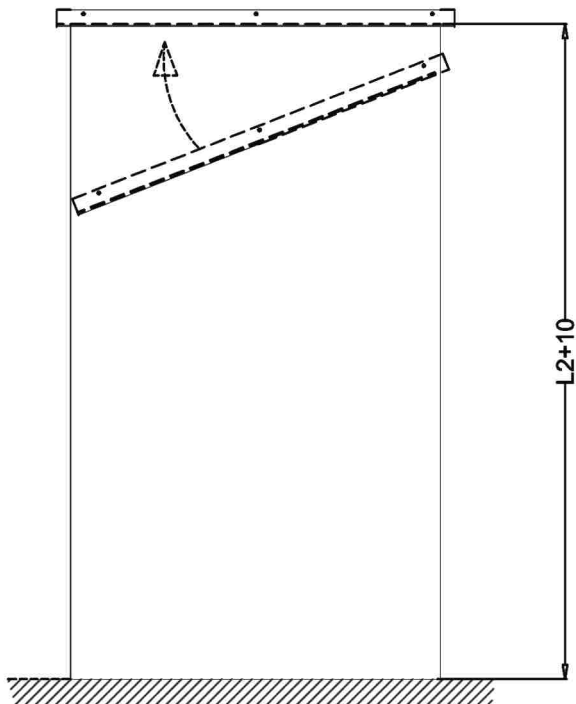

Assemble upper cross member
Insert stainless steel U section on panel

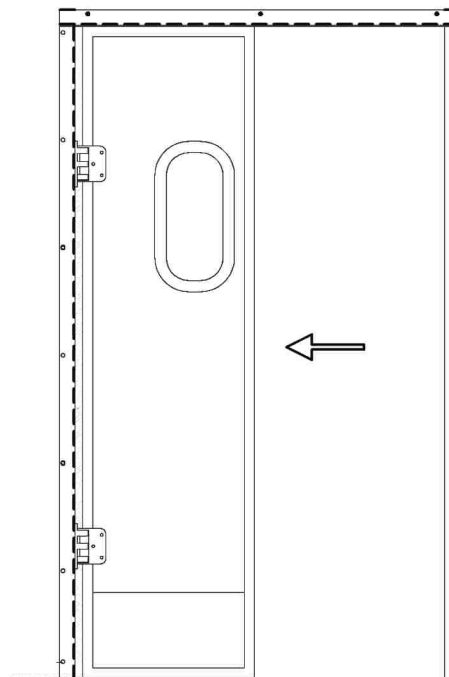

Assemble first wing
Insert stainless steel U section on panel

STEP 4

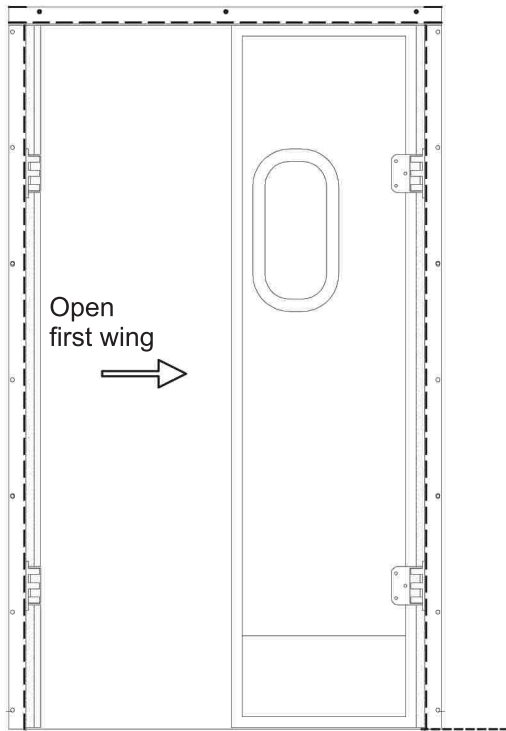

- Assemble second wing
- Insert stainless steel U section on panel

STEP 5

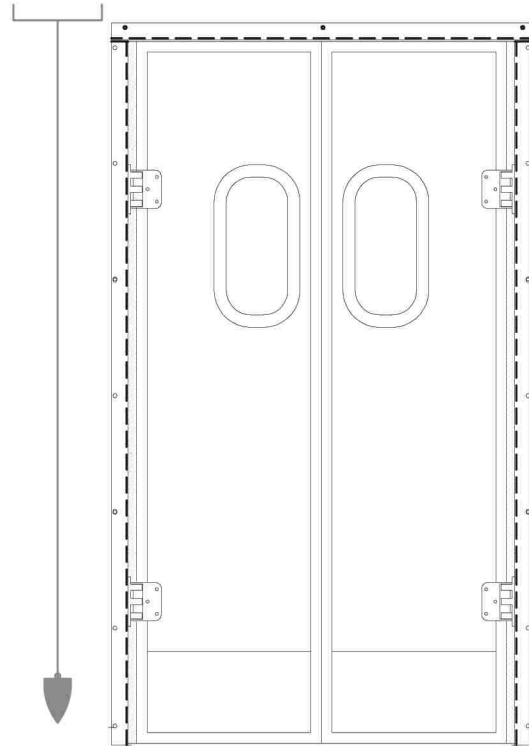

- Align the jambs of the two wings vertically
- Central gaskets must overlay by 10 mm
- Align upper cross member horizontally
- Fix stainless steel U section with screws or rivets

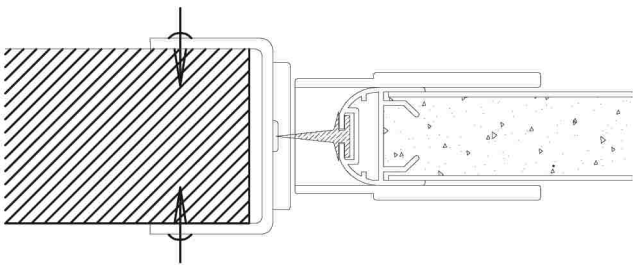

Fix with rivets or screws

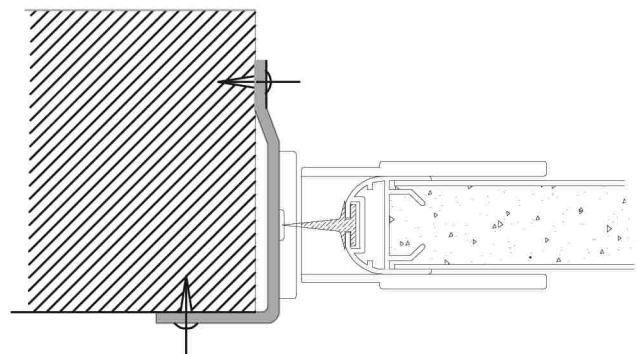
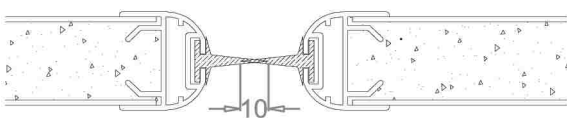

Secure on wall with dowels