

# Mod. SC - TN

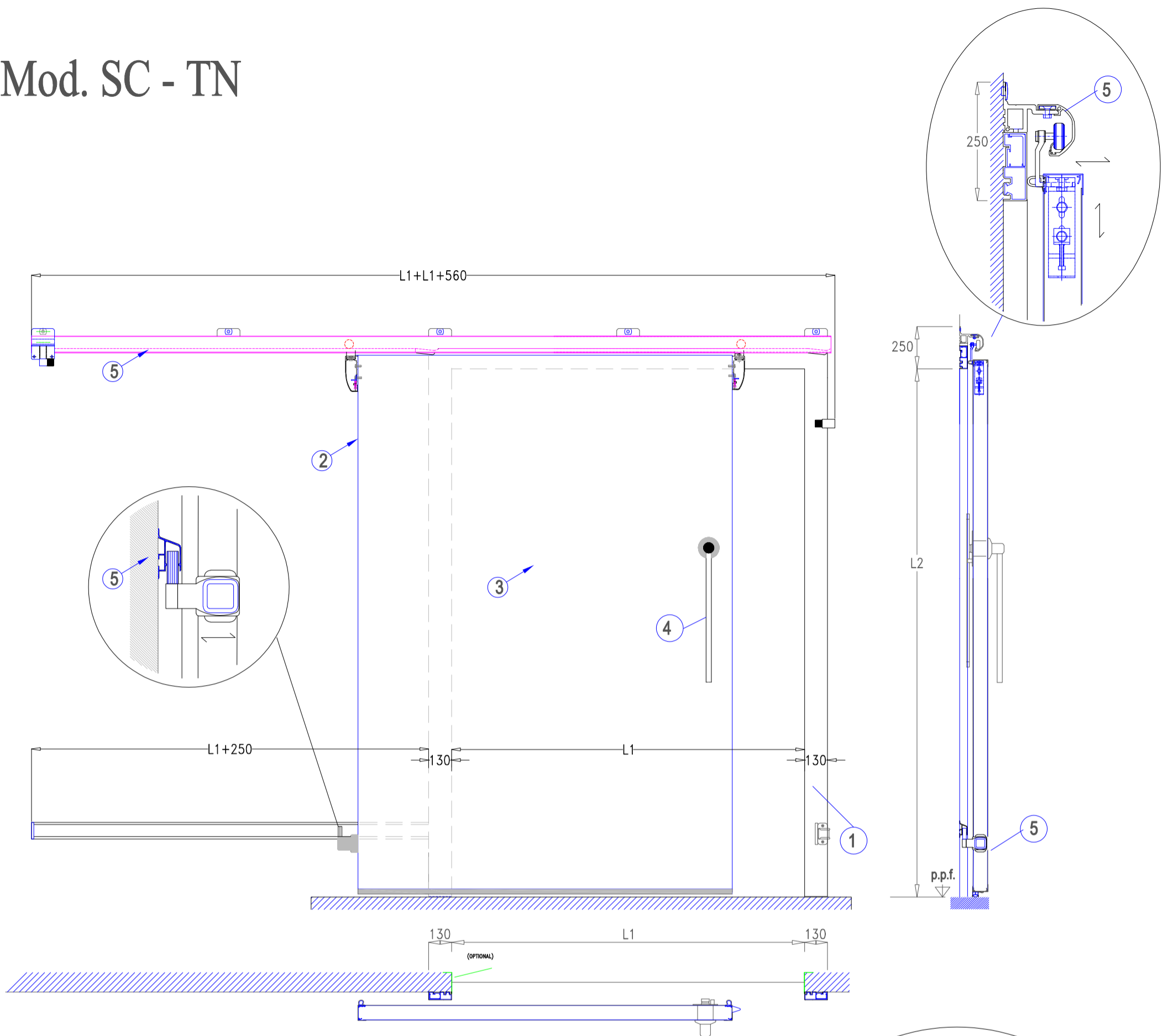

- |   |                       |   |                            |   |        |
|---|-----------------------|---|----------------------------|---|--------|
| ① | FRAME                 | ④ | HANDLE                     | ⑦ | GASKET |
| ② | EDGE OF THE DOOR LEAF | ⑤ | SLIDING RAILS IN ALUMINIUM |   |        |
| ③ | FACING DOOR           | ⑥ | THERMIC CUT                |   |        |

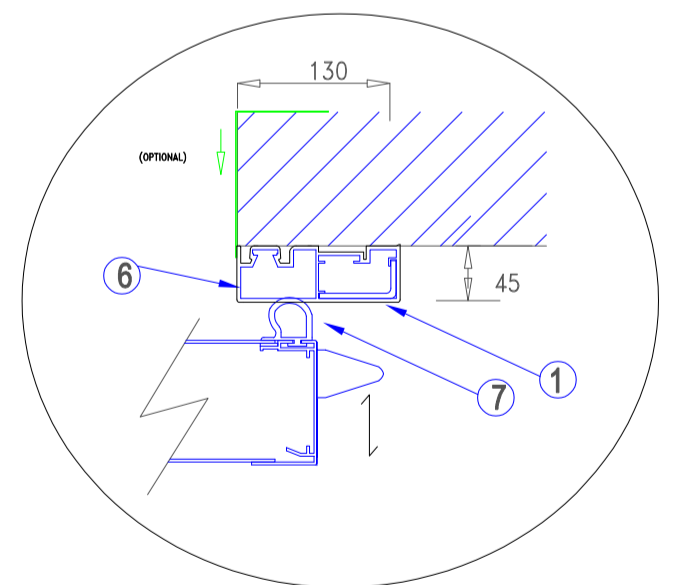

## Technical data of the hinged and sliding door

All the hinged doors and sliding door produced by A.E.G. SRL are insulated.  
The insulation is provided through polyurethane.

The doors leaf are characterized by and made up of:

4 different thicknesses: 66 mm, 86 mm, 126 mm, 150 mm, with

- edge border in aluminium or SS and the facing available in pre-painted metal, in stainless steel or fibreglass external faces.

- Core made of rigid oven baked foam polyurethane with the following structural characteristics and behaviour:

density  $\text{Kg/m}^3$  40-42

Closed cells content % > 95

Thermal conductivity  $\lambda$  0,020 - 0,023 w/mk

Insulating capacity:

k thickness 66 mm 0,31 w/m<sup>2</sup>k

k thickness 86 mm 0,24 w/m<sup>2</sup>k

k thickness 126 mm 0,16 w/m<sup>2</sup>k

k thickness 150 mm 0,14 w/m<sup>2</sup>k

 **sevenfrigo**  **FRIGO DOORS**

doors and cold rooms - By

 **AEG** s.r.l.

Ponte S. Giovanni - via della Tecnica, 44  
06135 - Perugia - ITALY

Tel. +30 - 075 - 5997648 / info@sevenfrigo.eu